

Recouvrement, sans espaceur
Overlay without a spacer

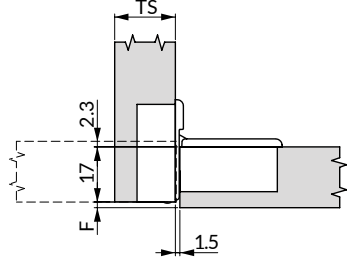

Recouvrement, avec 1 espaceur 1.5 mm (1x)
Overlay with a 1.5 mm spacer

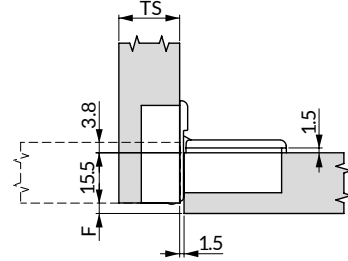

Recouvrement, 2 espaceur de 1.5 mm (2x)
Overlay with two 1.5 mm spacer

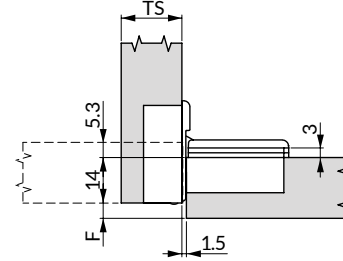

Recouvrement de 17 mm
Overlay of 17 mm

		Écart minimum <i>minimum gap</i> (F)	
Épaisseur de la porte (TS) Door thickness	14	1	
	15	1	
	16	1	
	17	1	
	18	1	
	19	1	
	20	1.5	
	21	2.5	

Recouvrement de 15.5 mm
Overlay of 15.5 mm

		Écart minimum <i>minimum gap</i> (F)	
Épaisseur de la porte (TS) Door thickness	14	1	
	15	1	
	16	1	
	17	1	
	18	1	
	19	1	
	20	1.5	
	21	2.5	

Recouvrement de 14 mm
Overlay of 14 mm

		Écart minimum <i>minimum gap</i> (F)	
Épaisseur de la porte (TS) Door thickness	14	1	
	15	1	
	16	1	
	17	1	
	18	1	
	19	1	
	20	1.5	
	21	2.5	

Réglage latéral
Lateral adjustments

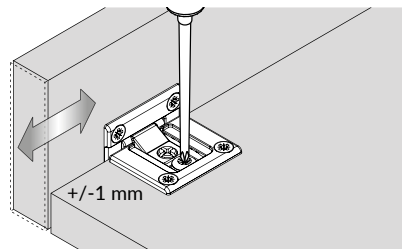

Réglage de la profondeur
Depth adjustments

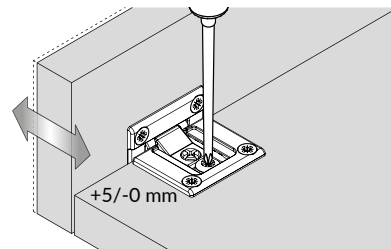

Réglage en hauteur
Height adjustments

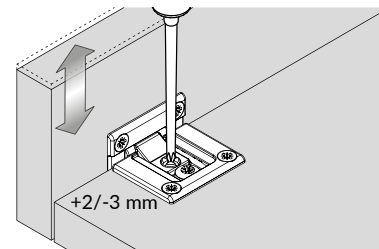

Schémas de perçage
Drilling pattern

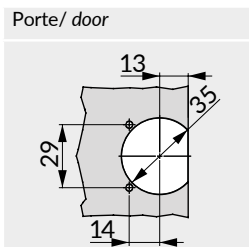

Profondeur de perçage
Drilling depth

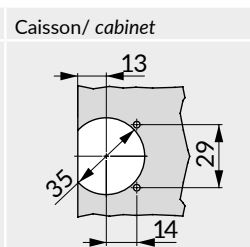

Dimensions boîtier
Overall dimensions

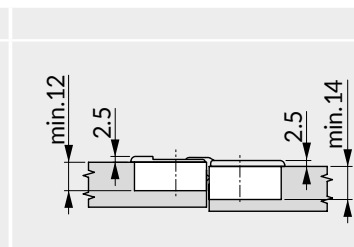

Dimensions boîtier
Overall dimensions

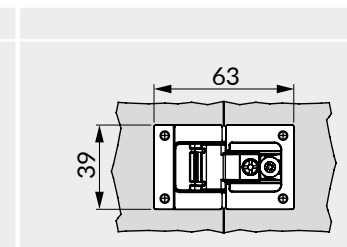

ESP-GTAB15-NK
Espaceur pour penture
d'abattant Tiomos fini nickel
*Tiomos flap hinge spacer,
nickel finish*



ESP-GTAB15-N
Espaceur pour penture
d'abattant Tiomos fini nuit
*Tiomos flap hinge spacer,
night finish*