



**WIND**  
***SALICE***



# WIND



The Wind lift system is characterised by compactness and elegant design.

Its movement is smooth and perfectly controlled. Wind is small and unobtrusive, enabling the maximum utilisation of cabinet internal space. Suitable for Kitchen cabinets, living room or bedroom furniture and office furniture.

In the kitchen environment, Wind has strong functional appeal - a compact adjustable lift system that takes up a minimum of valuable storage space.

Aesthetics also play a key role with Wind's small size and streamlined shape adding significantly to the overall appeal of the cabinets to which it is installed.

Wind is available in a range of attractive finishes designed to complement the vast range of cabinet applications that it can be used for.

Wind Lift system is a simple program that covers a large variety of door sizes.

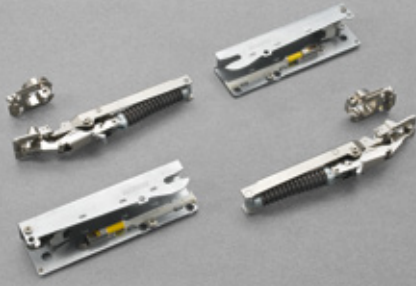

KIT PACKAGING	PART NUMBER	PACKAGING
	<p style="text-align: center;">SOFT CLOSE <b>FRAKFEX_SN9</b></p> <p>SPRING FORCE ↑</p>	<p>One box contains:</p> <ul style="list-style-type: none"> <li>2 hinge cups</li> <li>•</li> <li>1 Right hand lift mechanism</li> <li>1 Left hand lift mechanism</li> <li>•</li> <li>1 Right hand cabinet base</li> <li>1 Left hand cabinet base</li> <li>•</li> </ul> <p>Includes 5mm x 13mm system screws</p> <p>Note : #7 x 5/8" wood screws can also be used</p>
	<p style="text-align: center;">PUSH OPENING <b>FRAKFEP_SN9</b></p> <p>SPRING FORCE ↑</p>	

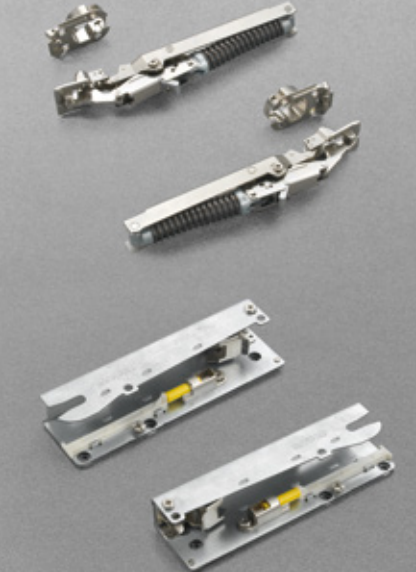
INDUSTRIAL PACKAGING	PART NUMBER	PACKAGING
	<p style="text-align: center;">SOFT CLOSE <b>FRAKINX_SN9</b></p> <p>SPRING FORCE ↑</p>	<p>One box contains:</p> <ul style="list-style-type: none"> <li>18 Hinge cups</li> <li>•</li> <li>9 Right hand lift mechanisms</li> <li>9 Left hand lift mechanisms</li> <li>•</li> <li>9 Right hand cabinet bases</li> <li>9 Left hand cabinet bases</li> <li>•</li> </ul> <p>Includes 5mm x 13mm system screws</p> <p>Note : #7 x 5/8" wood screws can also be used</p>
	<p style="text-align: center;">PUSH OPENING <b>FRAKINP_SN9</b></p> <p>SPRING FORCE ↑</p>	

COVERS	PART NUMBER	PACKAGING
	<p style="text-align: center;">KIT PACKAGING <b>SRXA78A_SNXXF</b></p> <p>COVER COLOR ↑</p>	<p>One box contains:</p> <ul style="list-style-type: none"> <li>1 Right hand cover</li> <li>1 Left hand cover</li> </ul> <p>Includes cover caps</p> <p>Note: can be personalized</p>
	<p style="text-align: center;">INDUSTRIAL PACKAGING <b>SRXA78A_SNXXI</b></p> <p>COVER COLOR ↑</p>	<p>One box contains:</p> <ul style="list-style-type: none"> <li>9 Right hand covers</li> <li>9 Left hand covers</li> </ul> <p>Includes cover caps</p> <p>Note: can be personalized</p>

**SPRING FORCE CODE**

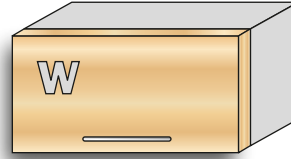
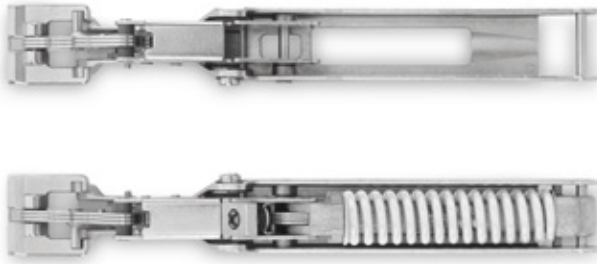

Min door weight - 1.75lbs  
Min door height - 8-5/8"

Max door weight - 11.5lbs  
Max door height - 12-9/16"

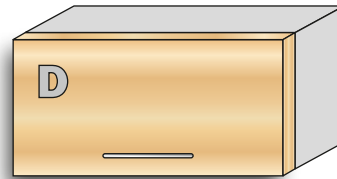
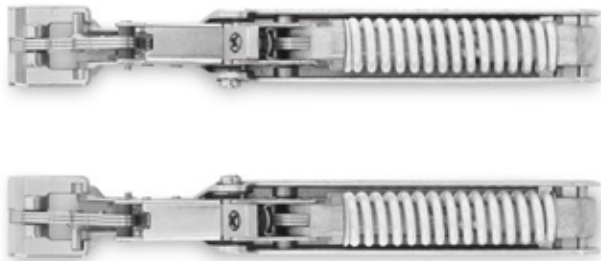

Min door weight - 4lbs  
Min door height - 8-5/8"

Max door weight - 17lbs  
Max door height - 24"

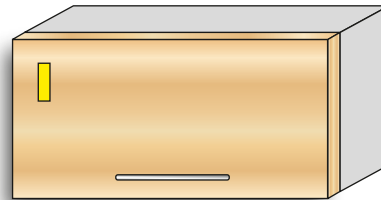
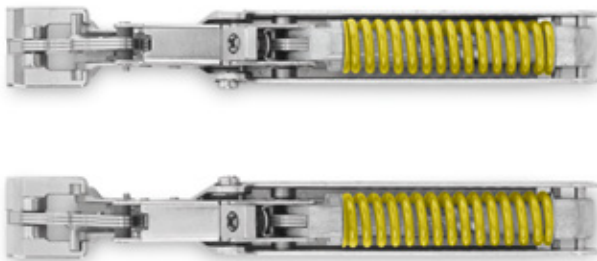

Min door weight - 10.5lbs  
Min door height - 12-9/16"

Max door weight - 21lbs  
Max door height - 24"

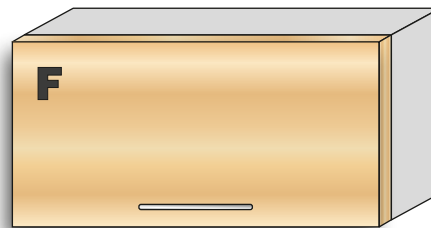

Min door weight - 18.5lbs  
Min door height - 12-9/16"

Max door weight - 32lbs  
Max door height - 24"

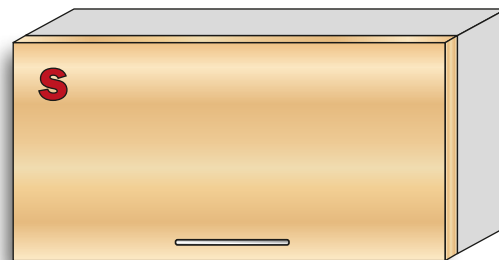
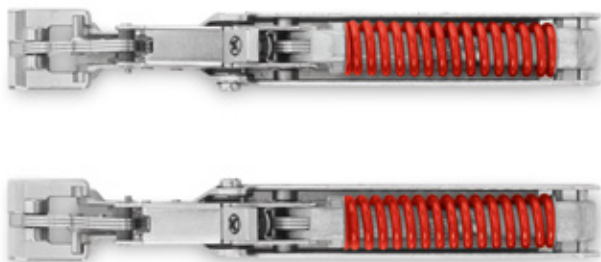

Min door weight - 26lbs  
Min door height - 12-9/16"

Max door weight - 41lbs  
Max door height - 24"

Note: When calculating door weight, include the weight of the decorative hardware.

**SRXA78A1SNXXI + S2MX83H9SN**

**MATTE WHITE**

Nickel plated cover cap



**SRXA78AISNXXI + S2MX83H9SN**

**STEEL**

Nickel plated cover cap



**SRXA78AGSNXXI + S2MX83H9SN**

**GREY**

Nickel plated cover cap



**SRXA78ACSNXXI + S2MX83H6SN**

**CHAMPAGNE**

Nickel plated cover cap

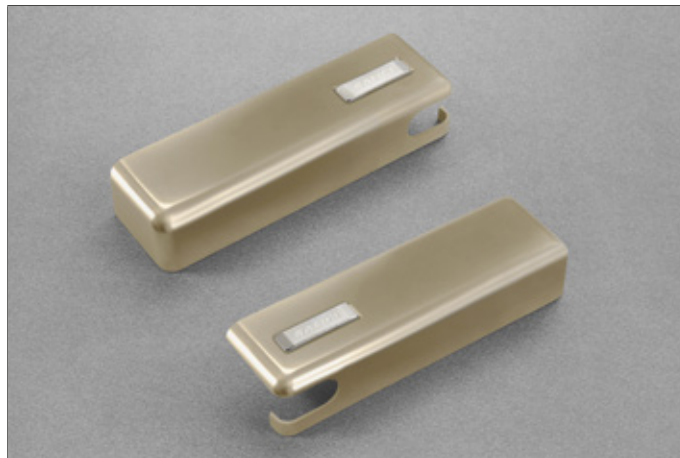

**SRXA78A0SNXXI + S2MX83H6SN**

**SATIN METAL BLACK**

Titanium cover cap



**SRXA78ANSNXXI + S2MX83H6SN**

**GLOSSY METAL BLACK**

Titanium cover cap



Drilling pattern

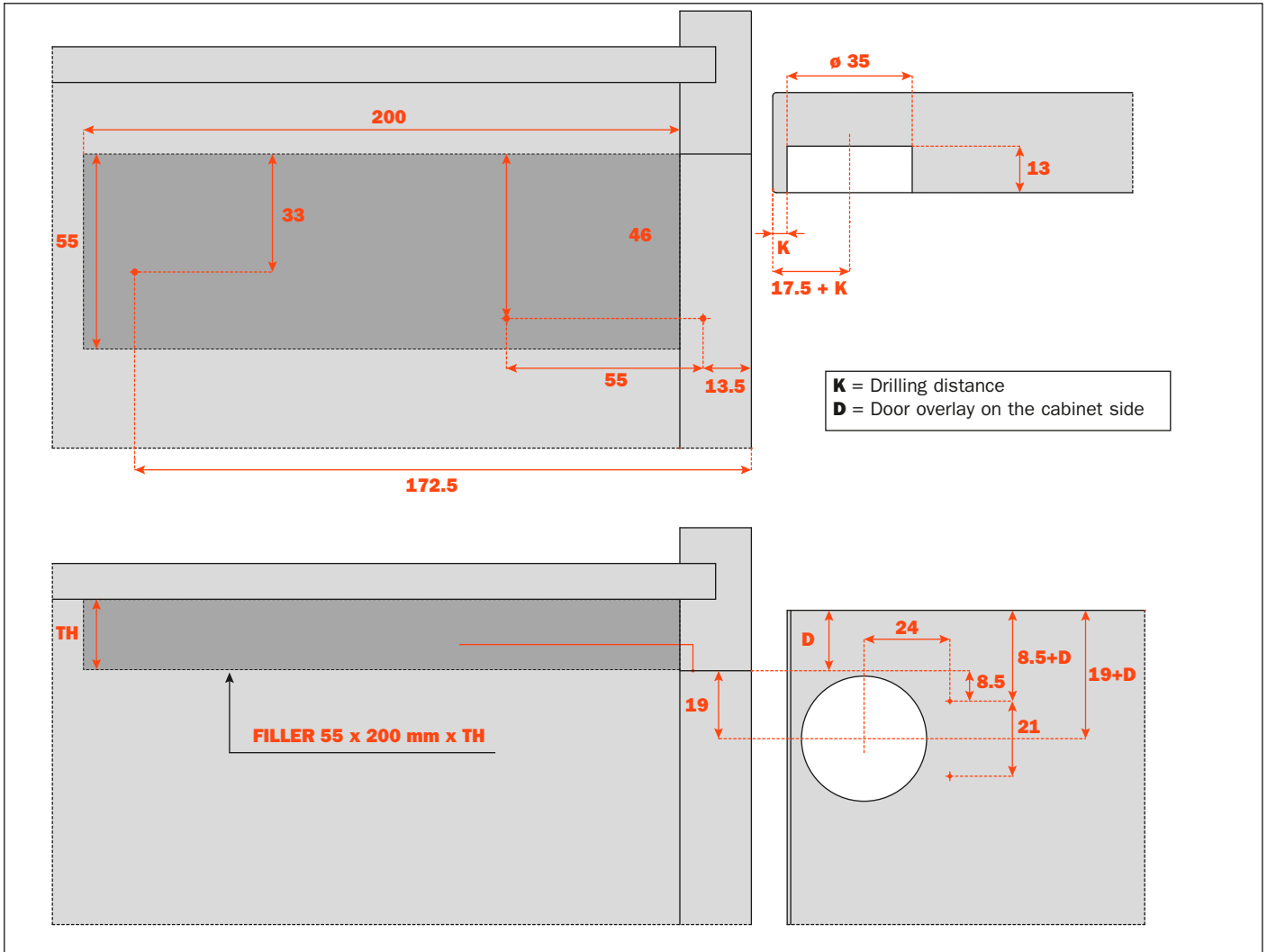

Space needed to open the door

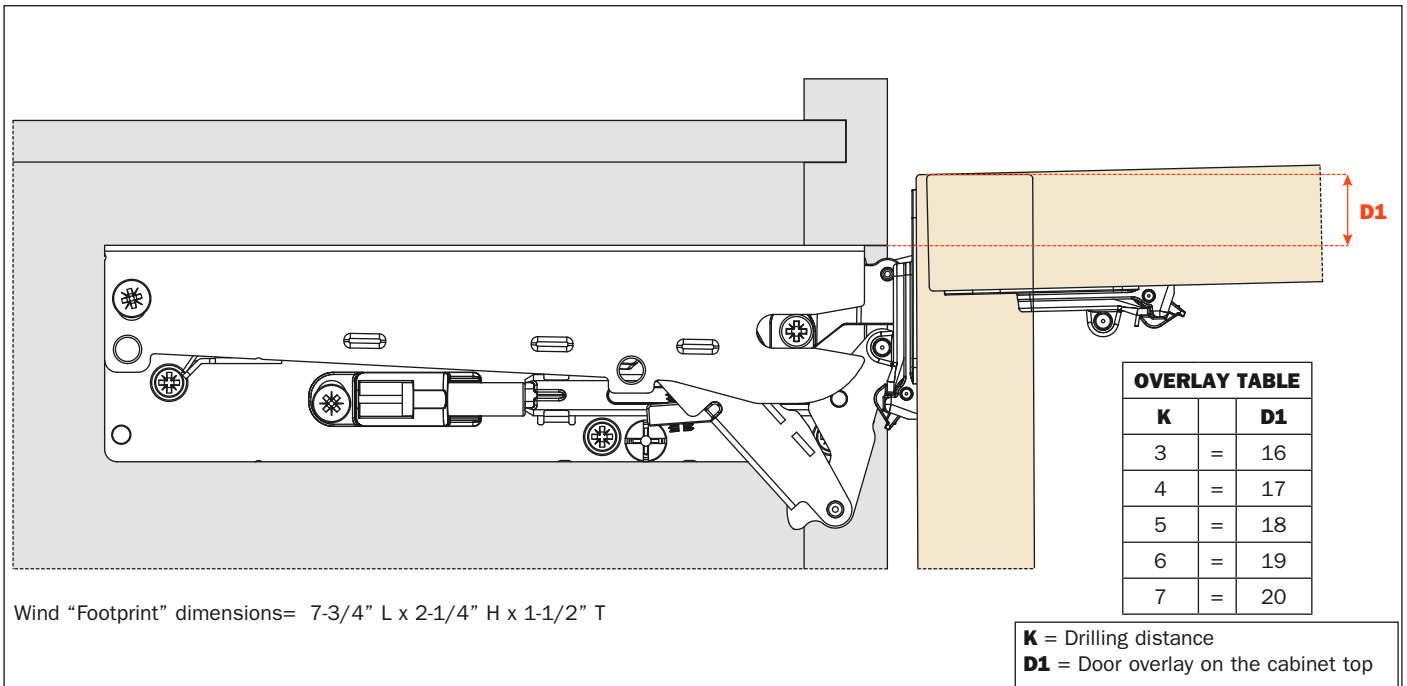

Wind "Footprint" dimensions= 7-3/4" L x 2-1/4" H x 1-1/2" T

K = Drilling distance  
D1 = Door overlay on the cabinet top

**Drilling pattern**

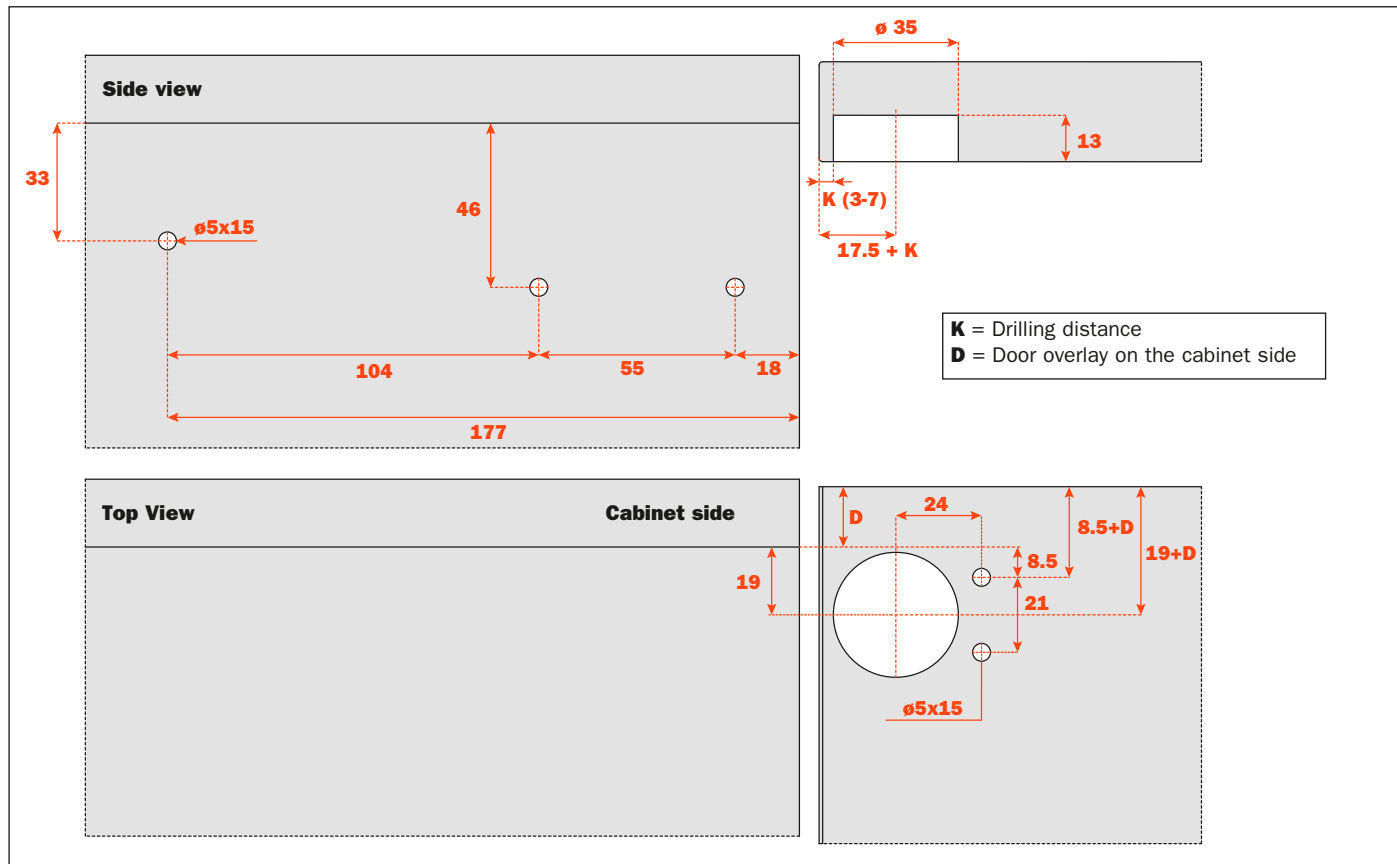

**Space needed to open the door**

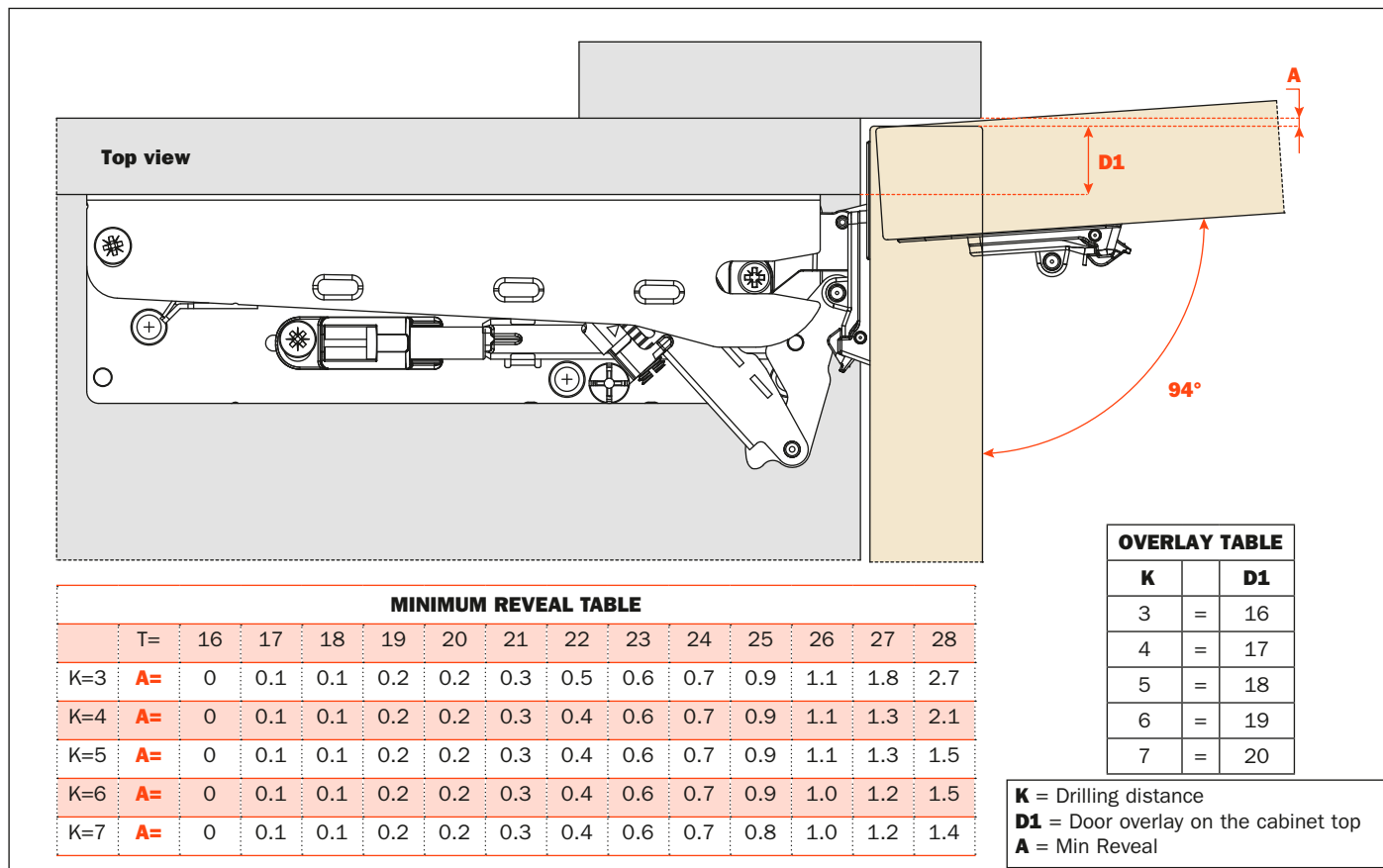



## Assembly instructions

### Attaching the base to the cabinet sides

Use 5mm x 13mm system screws or #7 x 5/8" wood screws.

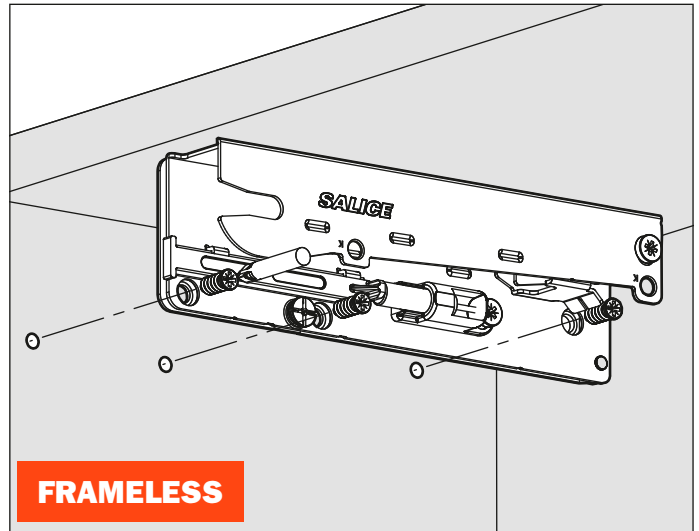
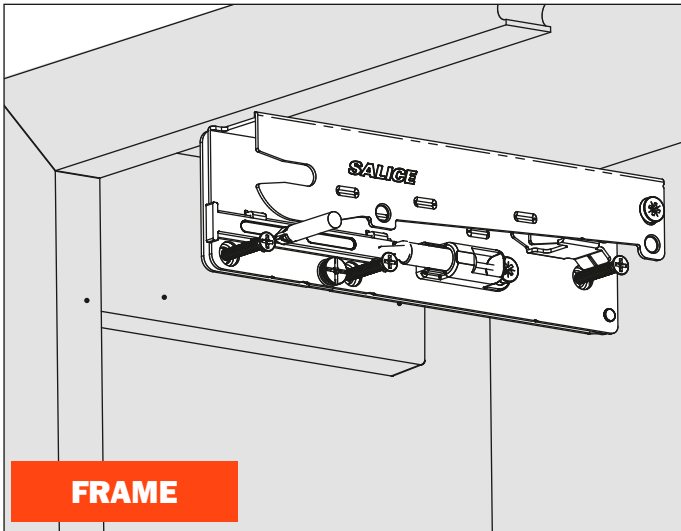

### Installing the cups to the door

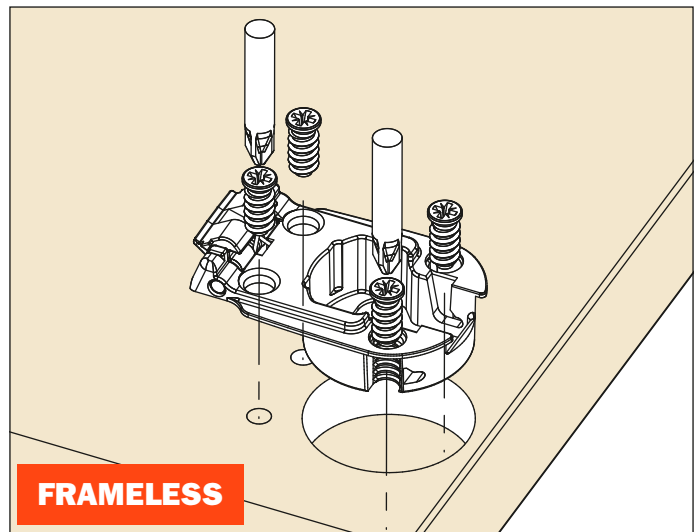
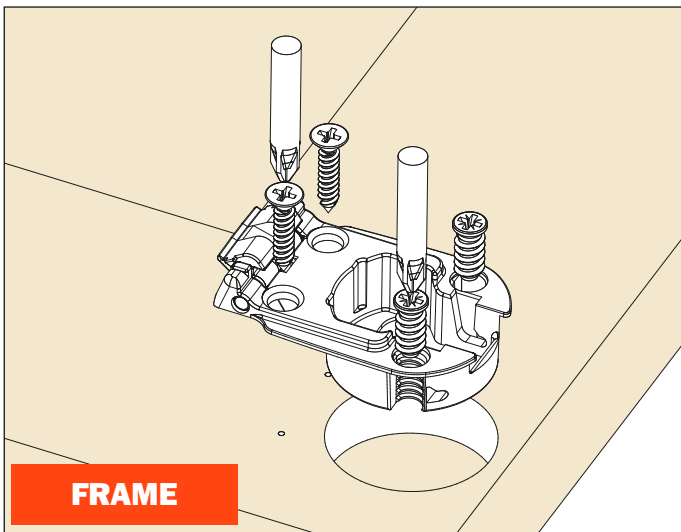

### Connecting the lift mechanism to the cups

Connecting the lift mechanism to the cups. This operation is tool free.

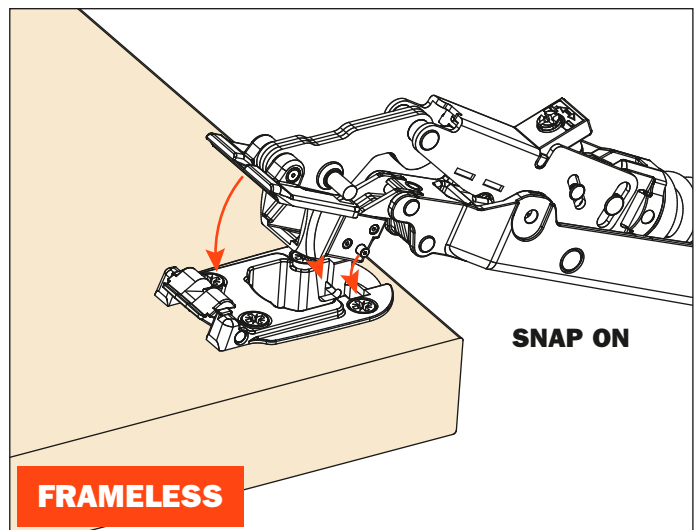
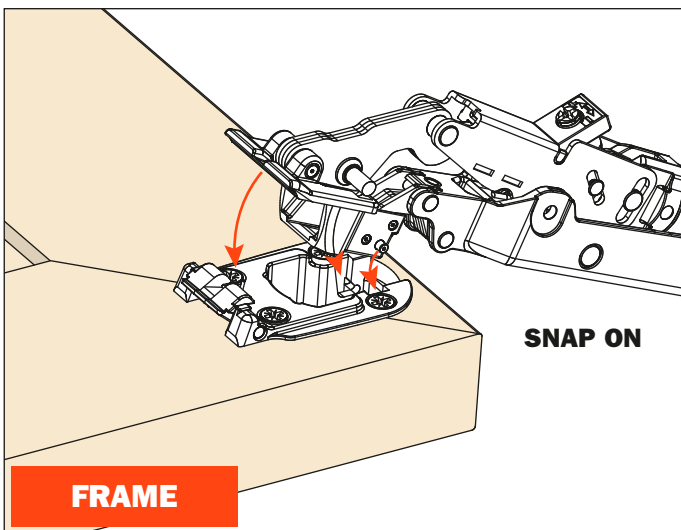

## Connecting the lift system to the base

Connecting the lift system to the base. This operation is tool free.

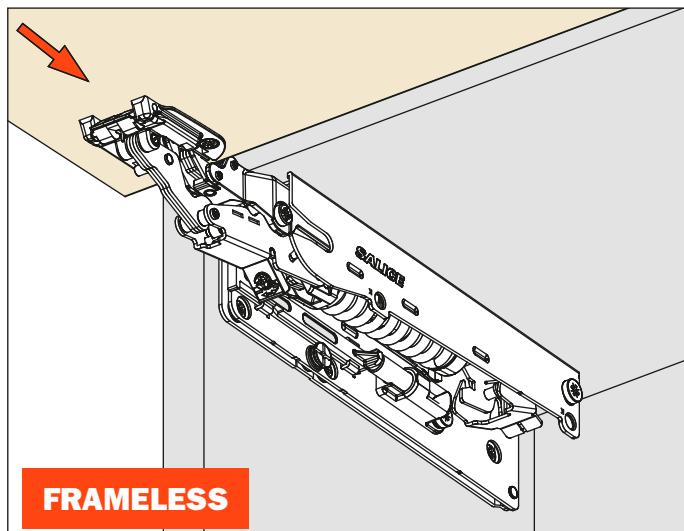
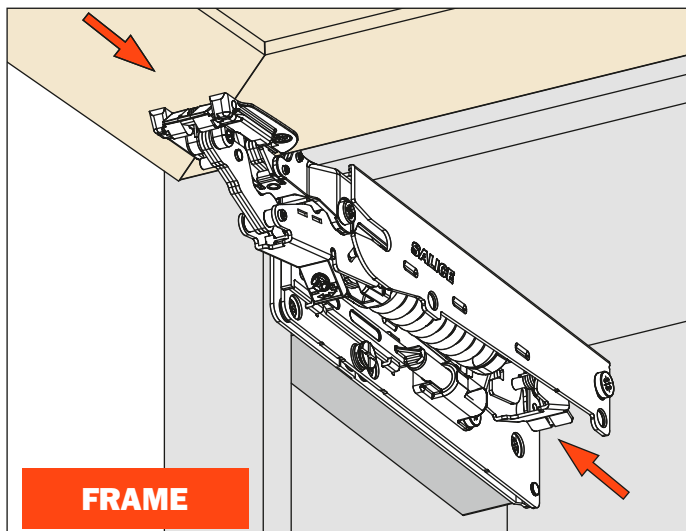

## Installing the covers

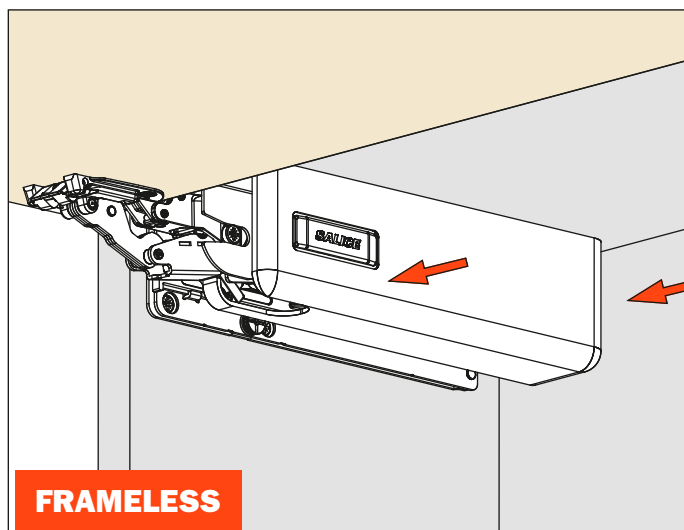
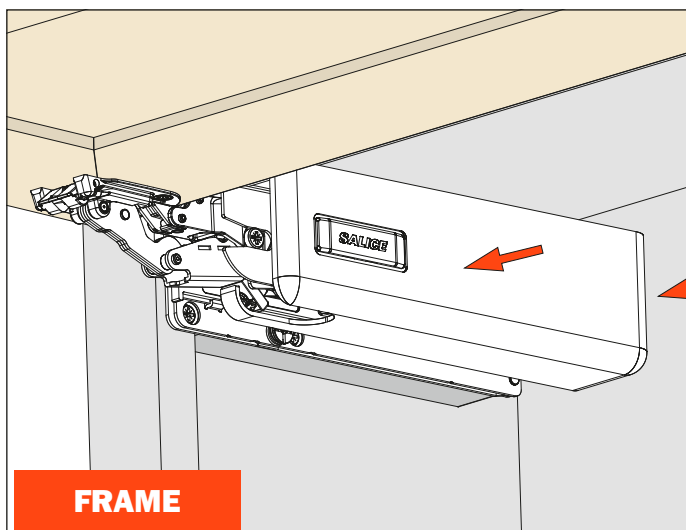

Removal of the covers

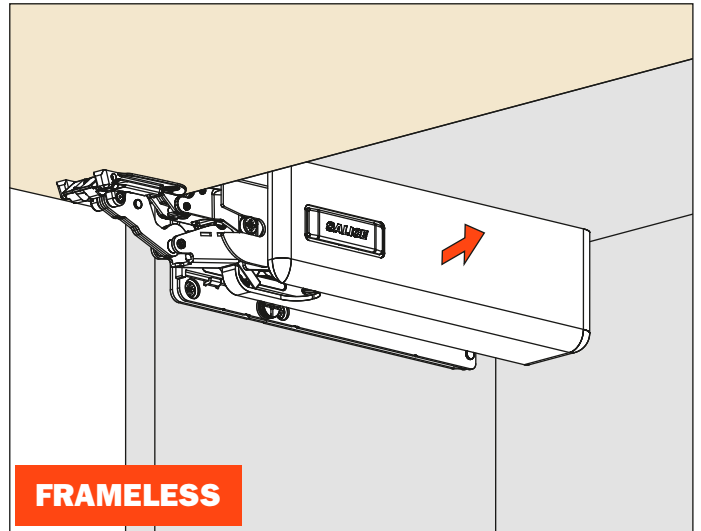
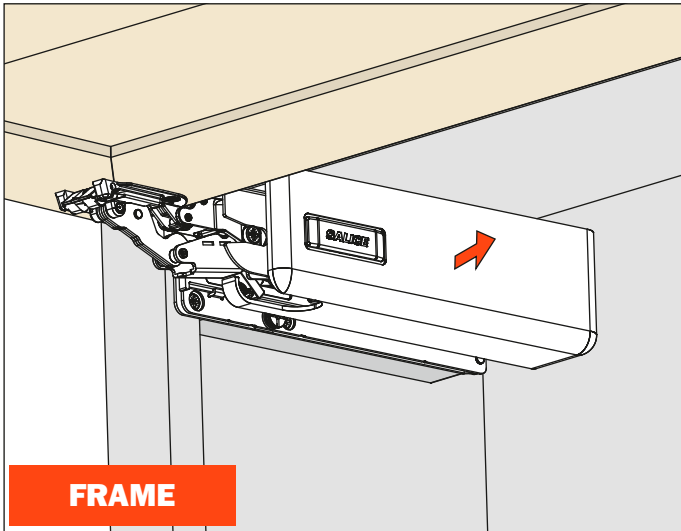

Disassembly of the system

Press the back lever and remove the lift mechanism. This operation is tool free.

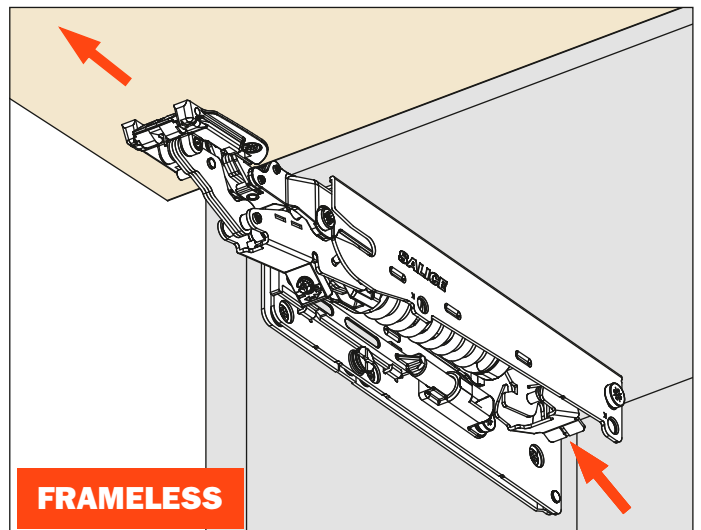
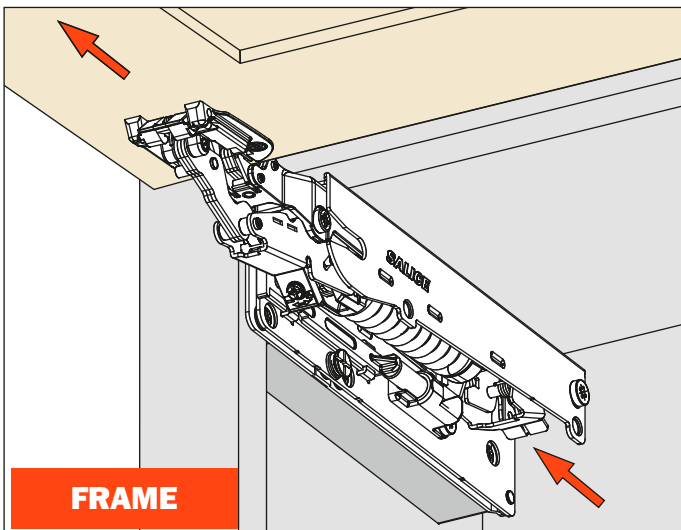

Remove the lift mechanism from the cups (door)

Disconnecting the system from the cups. This operation is tool free.

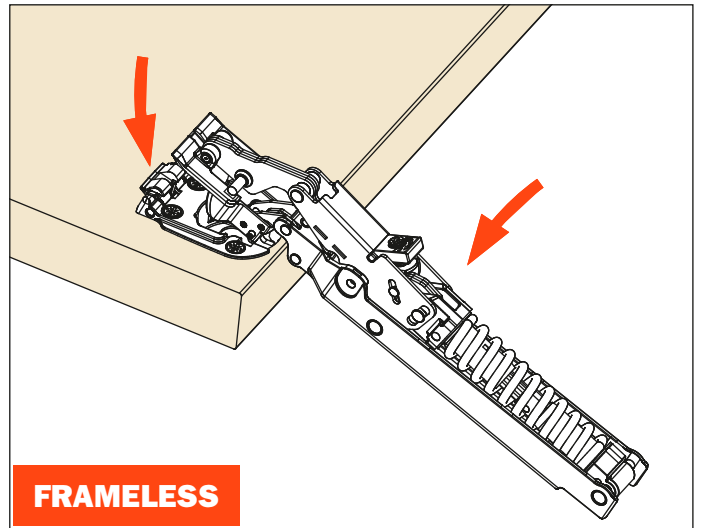
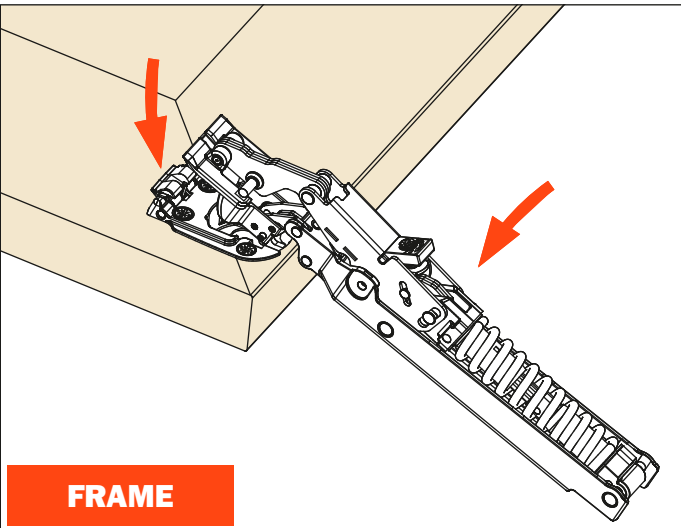

**1 - adjustment of the spring force**

**2 - adjustment of the soft close**

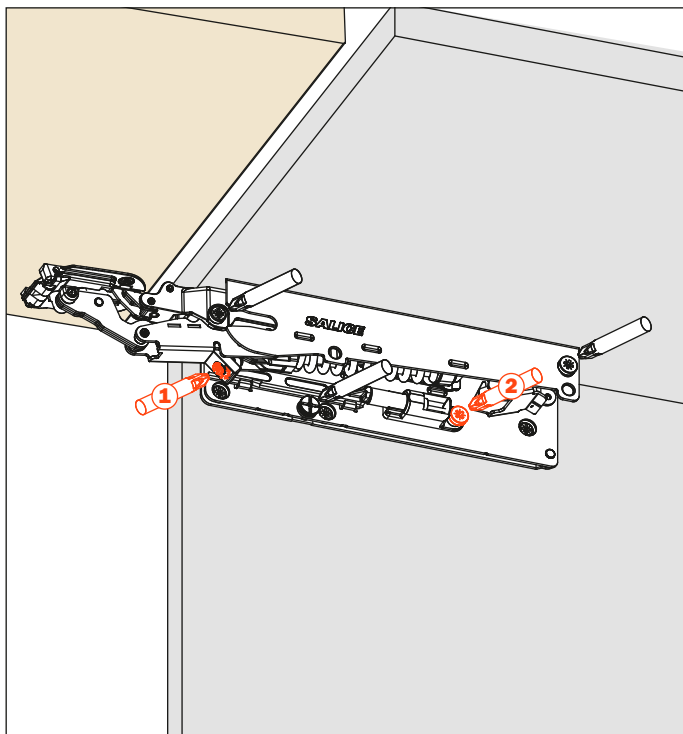
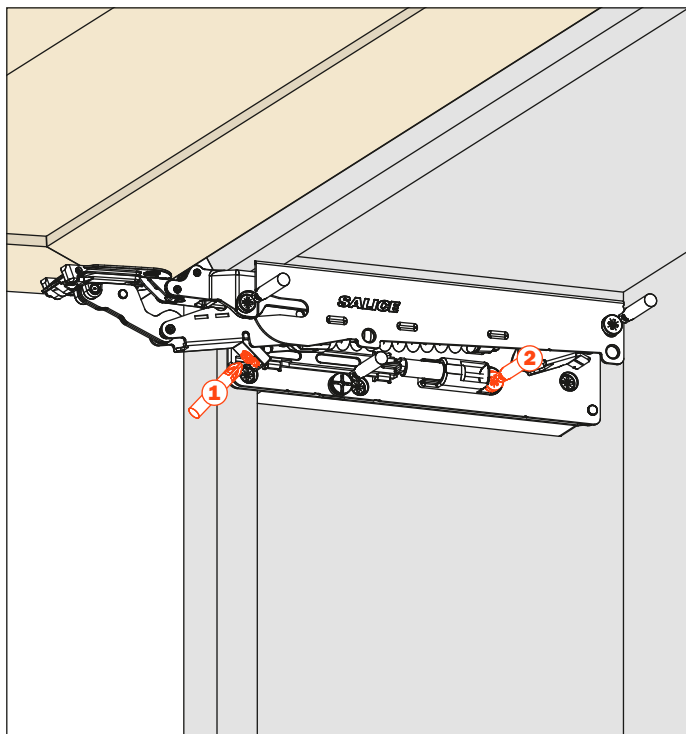

**3 - height adjustment of the door from +/- 2mm**

**4 - side adjustment of the door from +/- 2mm**

**5 - depth adjustment of the door from +3mm / -1mm**

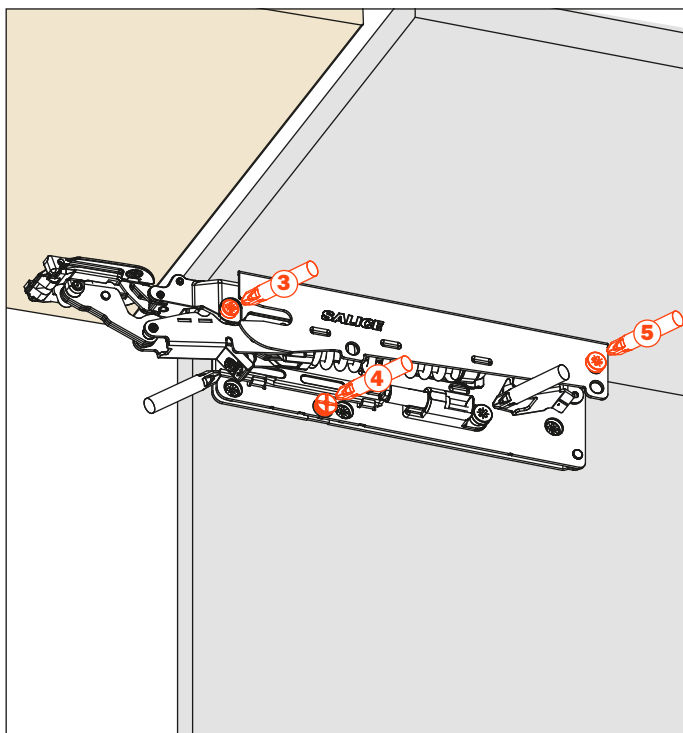
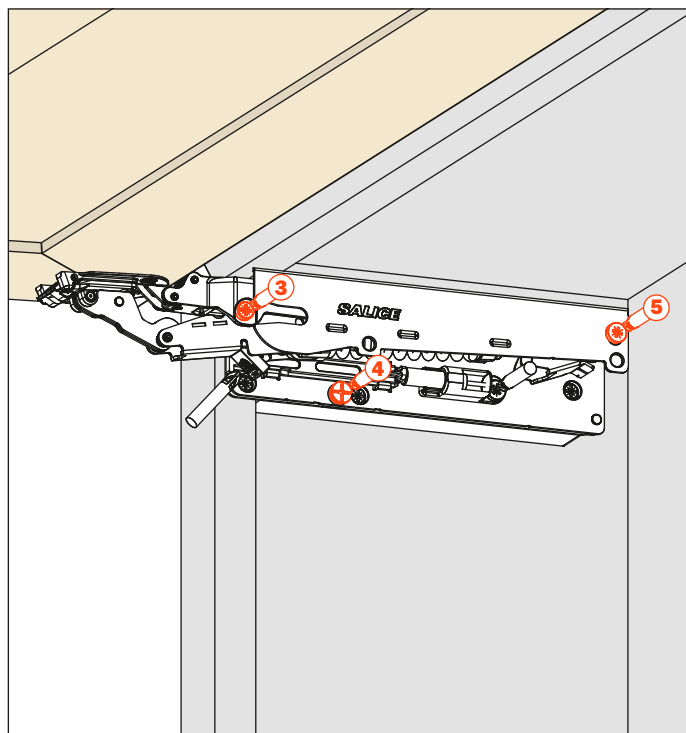

# Magnetic Push



**DPMSNB** - beige



**DPMSNG** - grey



Release device.  
ø 10 mm, 40 mm length.

**Packing**

Box 250 pieces  
Carton 1.500 pieces

**DPASNB** - beige



**DPASNG** - grey



Release device to be used to increase the magnetic holding strength. It must always be used together with the DPM. The suggested position of the DPM is the point of pressure on the door. The DPA can be positioned at any point along the opening edge of the door.  
ø 10 mm, 40 mm length.

**Packing**

Box 250 pieces  
Carton 1.500 pieces

**DP39XXG**



Adjustable magnetic catch. Inserted into the door.  
ø 15 mm

**Packing**

Box 250 pieces

**DP28SN9**



Retaining catch to be inserted with pin.  
ø 11.5 mm surface.

**Packing**

Box 250 pieces

**DP38XX91**



Retaining catch with adhesive.  
20x14 mm surface.

**Packing**

Box 250 pieces

## Release device application

### Release device to be inserted

Drill a hole  $\varnothing$  10 mm and min. 40 mm depth in the top, the side or the bottom panel of the cabinet.

Insert the release device into the hole.

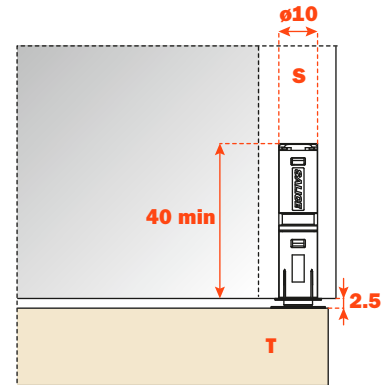

### Adjustable magnetic catch

The adjustable catch DP39 is itself magnetic and together with the magnetism of the release device DPM considerably increases the holding strength (30%) of the door against the cabinet side, thus avoiding accidental opening.

For the installation it is necessary to drill a hole  $\varnothing$ 15 mm and 11 mm depth in the door.

Depth adjustment from +2.5mm / - 0.5mm

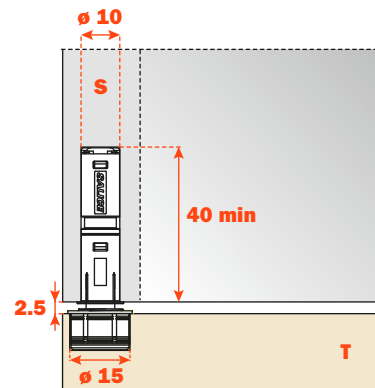

### Retaining catch to be inserted

Apply the retaining catch to the magnetic release device.

Close the door.

The point of the retaining catch will show where to insert it.

Reopen the door and press the retaining catch.

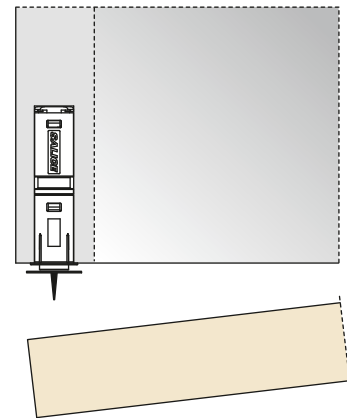

### Retaining catch with adhesive strip

Apply the retaining catch to the magnetic release device. Remove the protective strip from the adhesive. Close the door and the retaining catch is positioned on the door.

Reopen the door and apply a firm pressure to the retaining catch to ensure a correct installation.

#### ATTENTION:

For a correct application and to ensure optimal endurance, we suggest these guidelines are followed:

- 1 - clean and degrease the door surface where the retaining catch is to be installed;
- 2 - remove the protective strip from the adhesive;
- 3 - place the retaining catch in position, in a place that is at room temperature  $\geq 10^{\circ}$  ( $50^{\circ}\text{F}$ ) and apply a firm pressure for 10-15 seconds.

After few seconds from the installation the retaining catch is suitable for the use.  
After 24h the max. hold is attained.

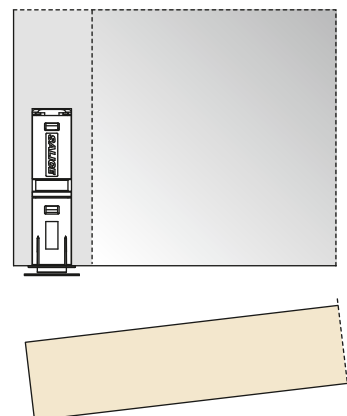

**FRAME**

Where to apply the Push devices

**Narrow Cabinet  
1 Push device**

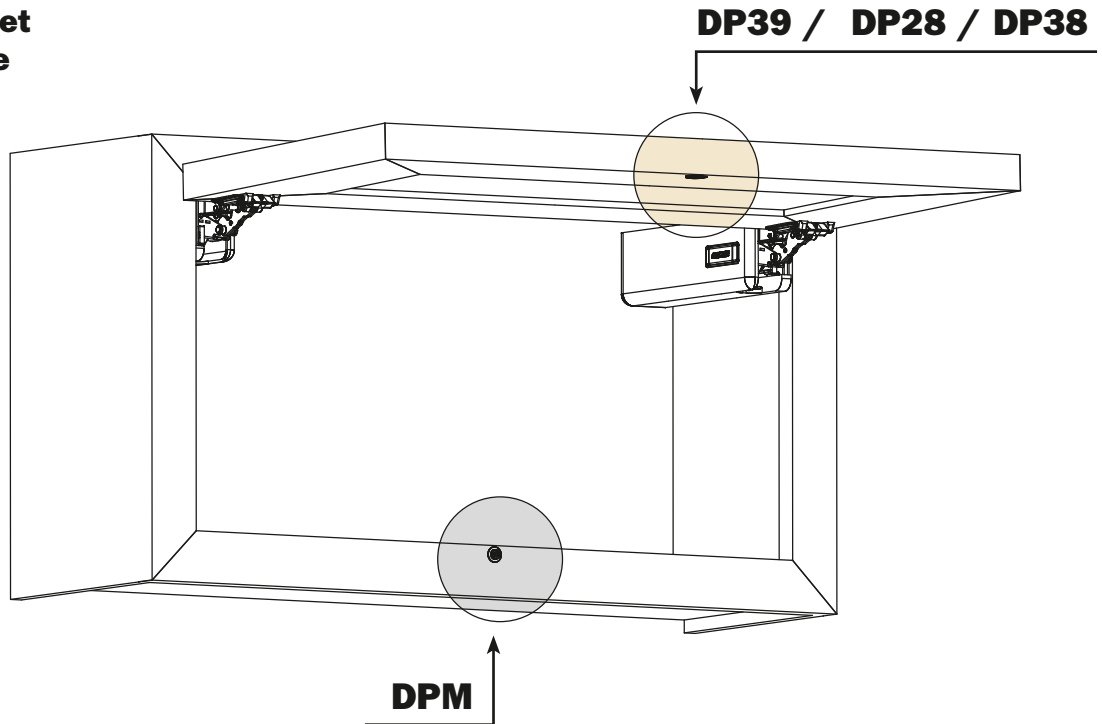

**Wide Cabinet  
2 Push devices**

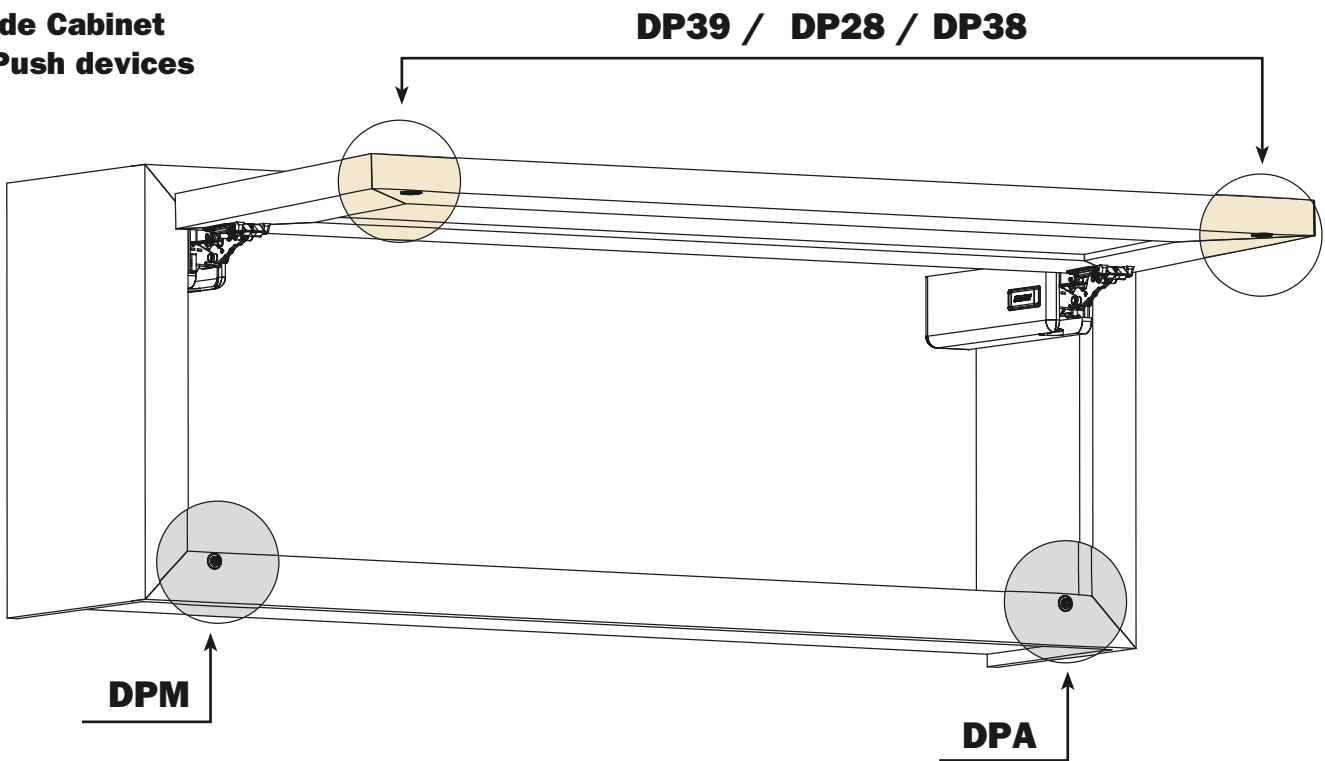



**FRAMELESS**

Where to apply the Push devices

**Narrow Cabinet**  
**1 Push device**

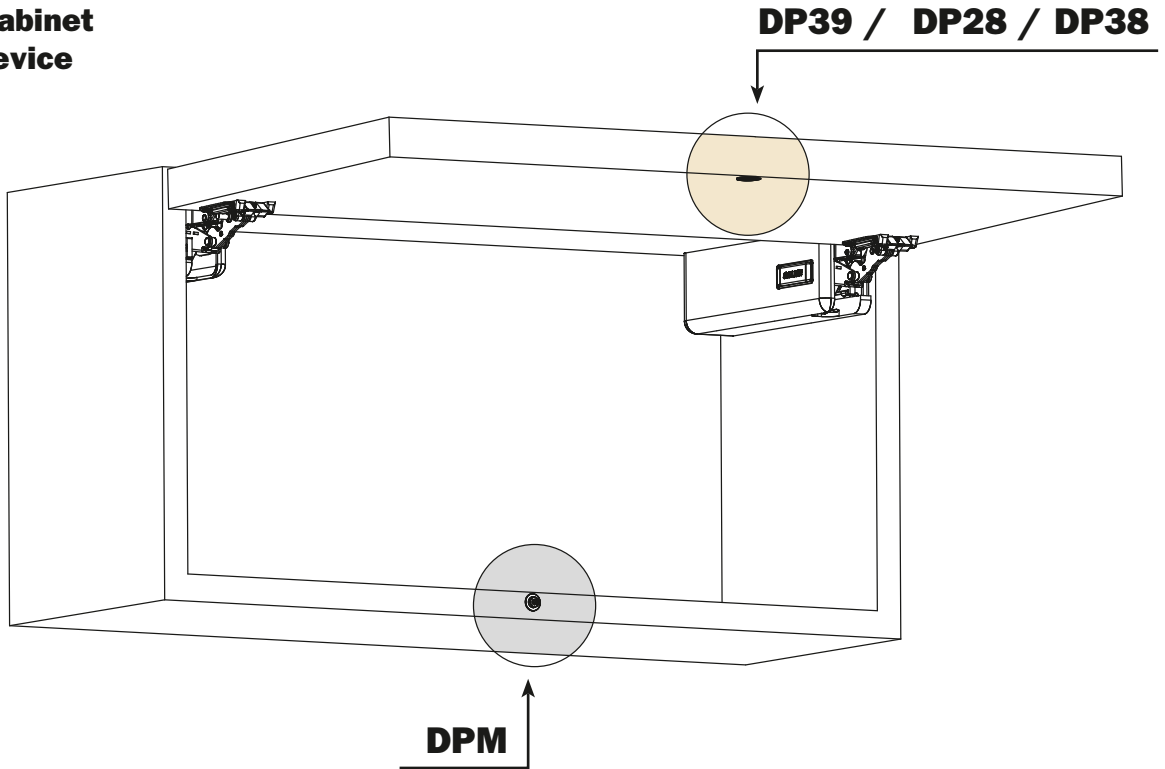

**Wide Cabinet**  
**2 Push devices**

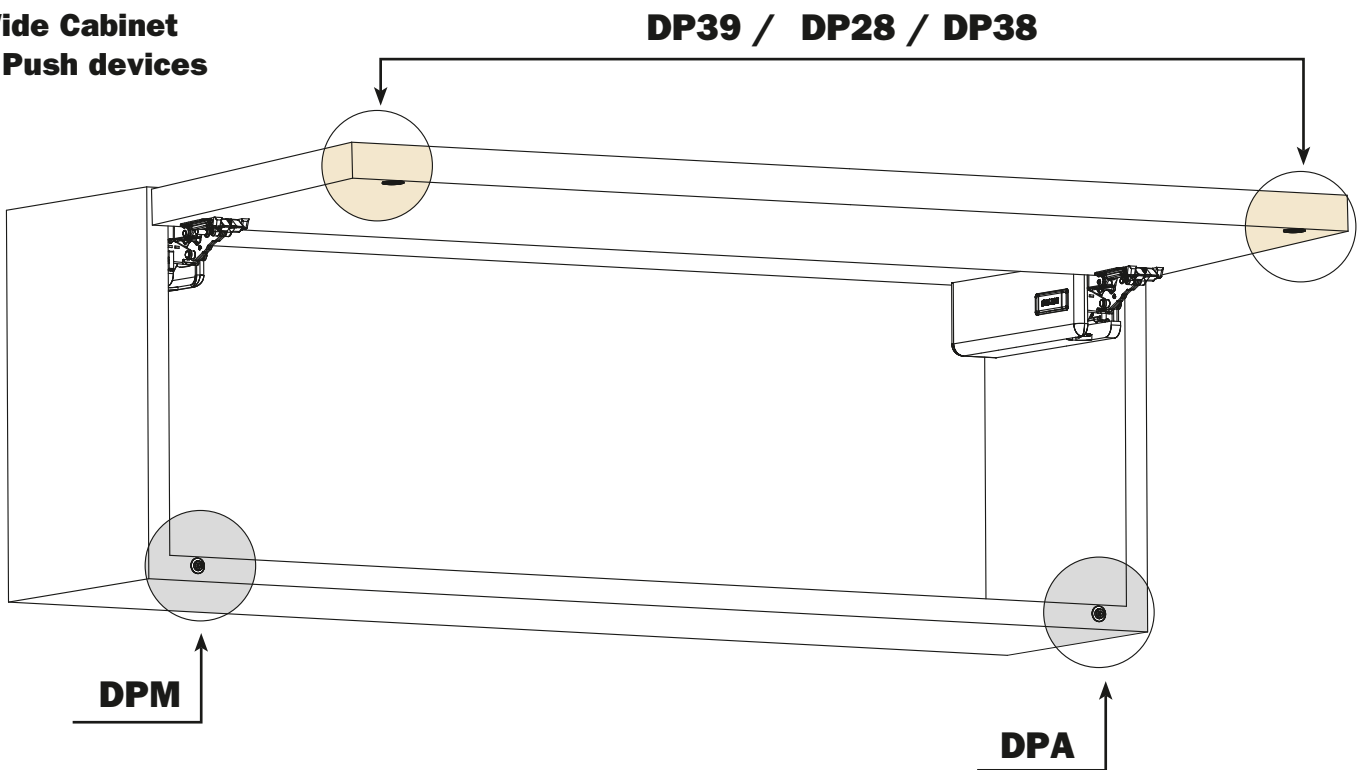

# WIND Weight / Height Tables

Use these tables to choose the correct Lift mechanism based on door weight and dimension.  
 Note: When calculating door weight, include the weight of the decorative hardware.

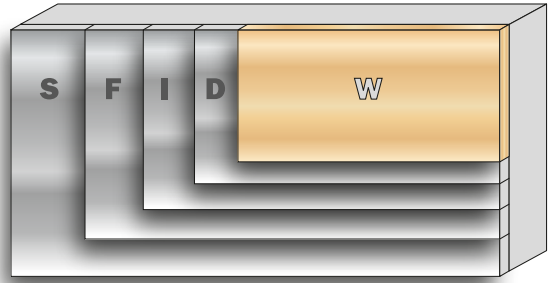
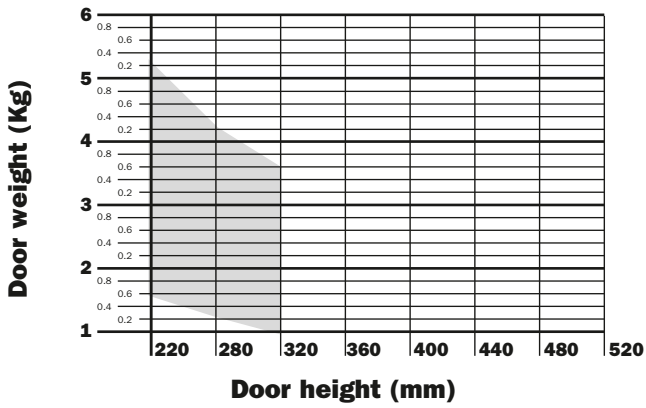

Min door weight - 1.75lbs  
 Min door height - 8-5/8"

Max door weight - 11.5lbs  
 Max door height - 12-9/16"

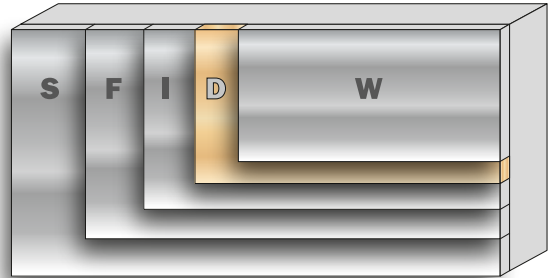
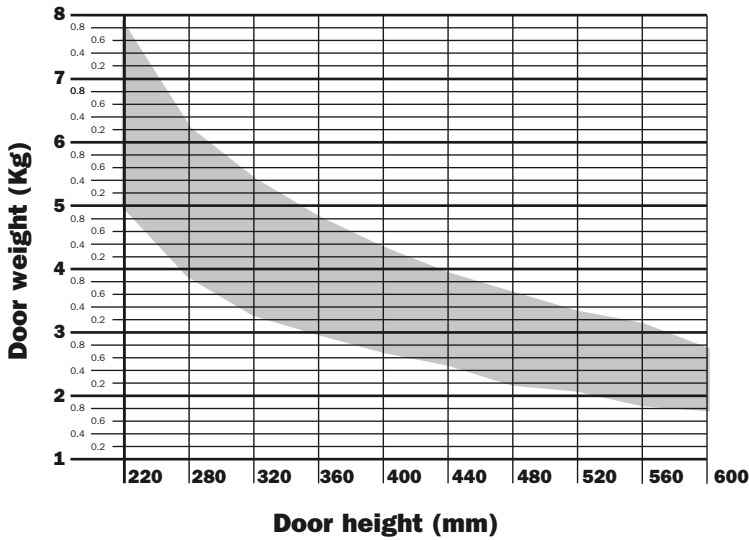

Min door weight - 4lbs  
 Min door height - 8-5/8"

Max door weight - 17lbs  
 Max door height - 24"

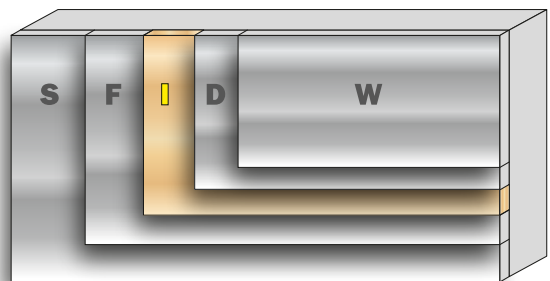
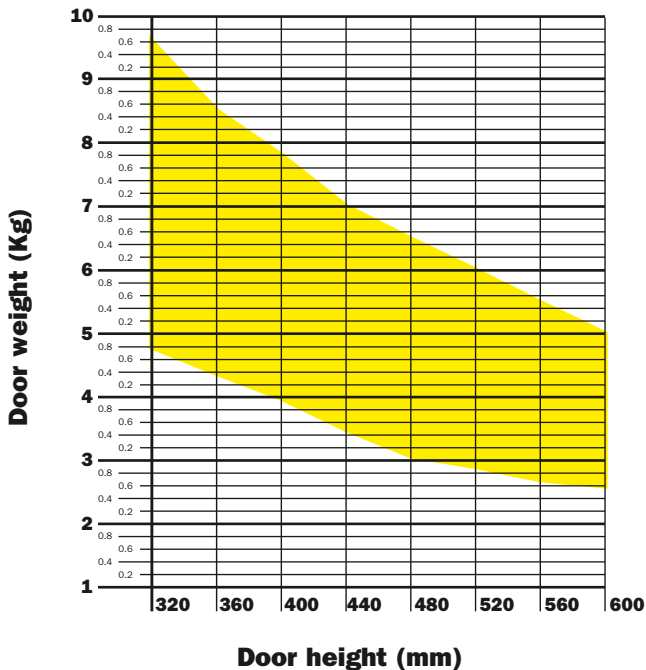

Min door weight - 10.5lbs  
 Min door height - 12-9/16"

Max door weight - 21lbs  
 Max door height - 24"

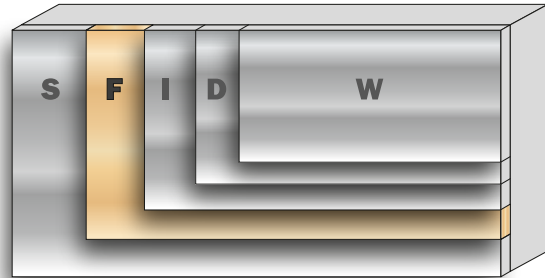
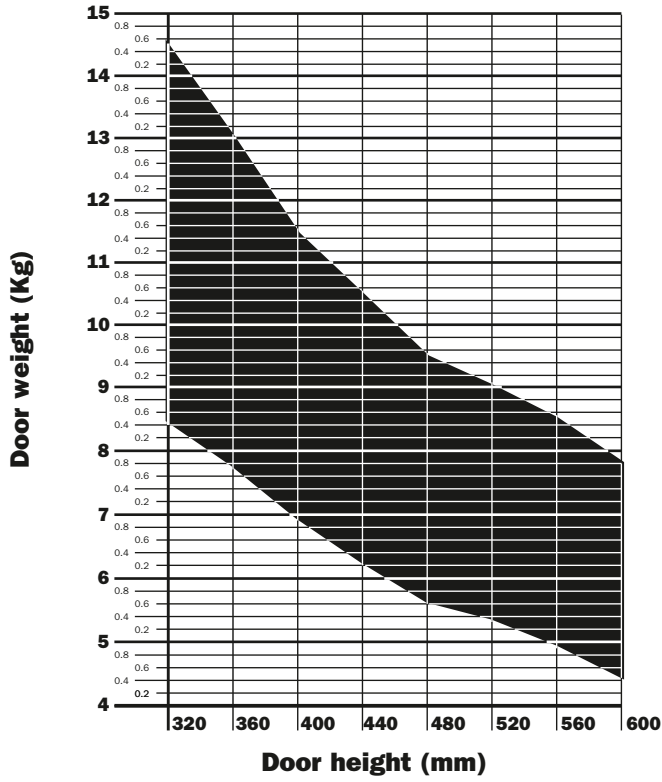

Min door weight - 18.5lbs  
Min door height - 12-9/16"

Max door weight - 32lbs  
Max door height - 24"

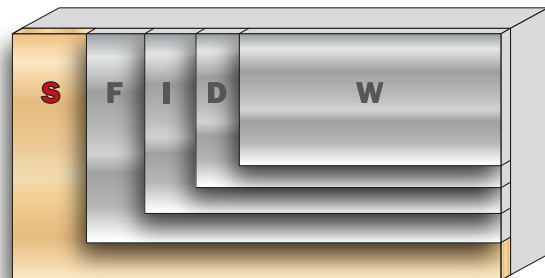
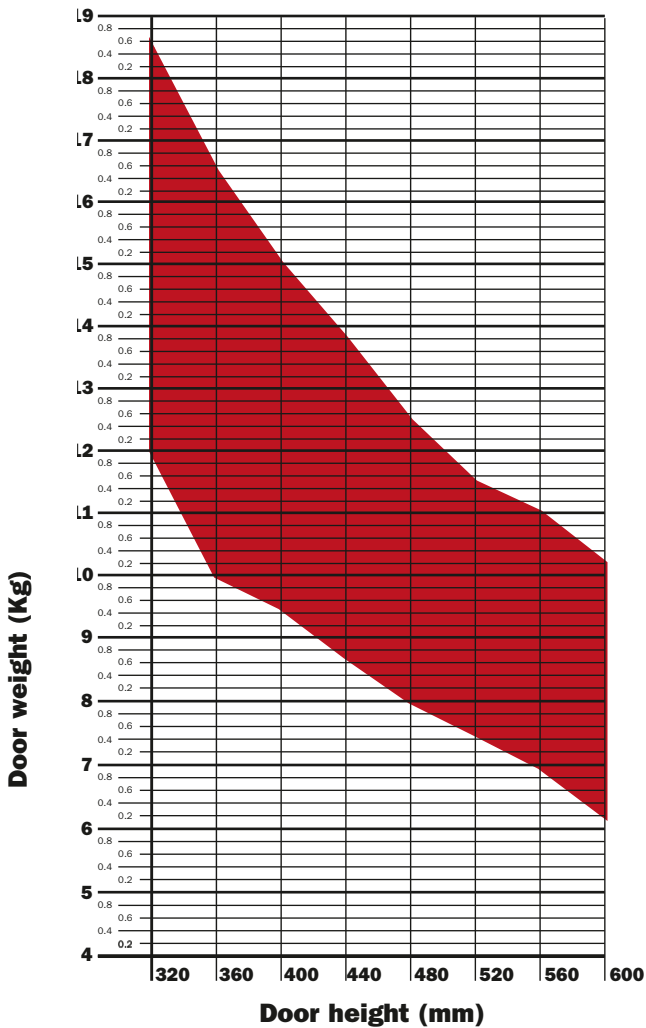

Min door weight - 26lbs  
Min door height - 12-9/16"

Max door weight - 41lbs  
Max door height - 24"

**SALICE AMERICA INC.**

2123 CROWN CENTRE DRIVE  
CHARLOTTE NC. 28227  
TEL. 1-800-222-9652  
704 8417810  
FAX 704 8417808  
info.salice@saliceamerica.com  
www.saliceamerica.com

**SALICE CANADA INC.**

4025 SLADEVIEW CRESCENT  
UNIT # 7-9  
MISSISSAUGA, ONTARIO L5L 5Y1  
TEL. 905 8208787  
FAX 905 8207226  
info.salice@salicecanada.com  
www.salicecanada.com